

YHG-IR EX-PROOF INFRARED

PRODUCT FEATURES

- High quality infrared diode, long life use
- Infrared wavelength 830m/950m
- Auto setup or shut off according to environment
- Stainless steel housing
- IP65
- To work with ex-proof pan/tilt and ex-proof camera
- Indoor and outdoor for all weather use



PRODUCT DESCRIPTION

YHG-IR as a ex-proof ITV design equipment, could offer an excellent monitoring image for system.

Infrared shooting distance and angle could be adjusted and for different environment, it has different shooting result

Voltage supply 165VAC~265VAC

To knowledge and judge environment light, manually adjust setup or off scope, default value 5Lux~10Lux

Widow adopts special steel flat glass to ensure a good infrared shooting

Working under -45°C to +60°C for long time stably

To mount by camera or pan/tilt base and brackets

TYPE

- | | |
|-----------|----------------------------------|
| YHG-IR100 | Ex-proof infrared, distance 100m |
| YHG-IR50 | Ex-proof infrared, distance 50m |



CHANGZHOU YUHUA ELECTRIC EQUIPMENT MANUFACTURING CO.LTD
ADDRESS: NO 60 HEHUAN ROAD, ZHONGLOU DEVELOPMENT ZONE, CHANGZHOU JIANGSU, CHINA
TEL: 86-519-3978591 POSTAL: 213023
FAX: 86-519-3978970 WEB: <http://www.cyh.com.cn>

2006.10 VER: 1.1



YHG-IR EX-PROOF INFRARED

CERTIFICATE

Ex-marking	Exd II CT5
Certificate	CNEx04.1120
License	XK06-123-00256

ELECTRICAL

Input voltage	165VAC~265VAC, 50/60Hz	
Working current		
YHG-IR100	<500mA	
YHG-IR50	<300mA	
Shooting distance		
YHG-IR100	100m	
YHG-IR50	50m	
View angle	30°/60°	
Infrared diameter	Φ5mm	
Wave	830nm / 950nm	
Power consumption		
YHG-IR100	60W	
YHG-IR50	30W	
Electric connection	2-core power cable	

MECHANICAL

Material	Stainless steel 1Cr18Ni9Ti or 316L
IP	IP65
Weight/ship weight	
YHG-IR100	11Kg / 14Kg
YHG-IR50	8Kg / 11Kg
Dimension	
YHG-IR100	254(L) x 220(H) x 210(W) mm
YHG-IR50	254(L) x 170(H) x 160(W) mm
Cable outlet	1
Outlet type	G-3/4"
Mounting	Camera or pan/tilt base or brackets

ENVIRONMENTAL

Air pressure	86~106KPa
Temperature	-45℃~+60℃
Humidity	≤95%RH(+25℃)

DIMENSION

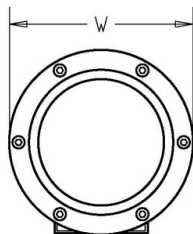

Face view

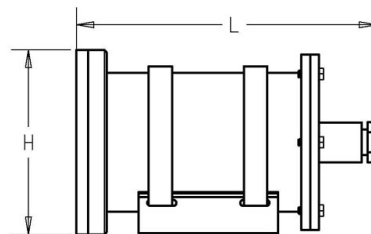

Side view

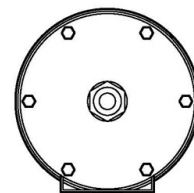

Rear view

MOUNTING SIZE

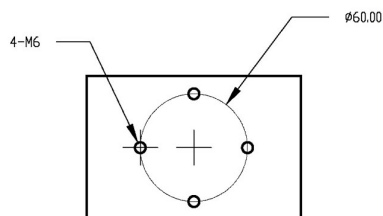

Bottom mounting hole

	IR100	IR50
L	254	254
W	210	160
H	220	170

Unit: mm